



The Mystery on Alaska's

IDITAROD TRAIL

Teacher's Guide

by

Carole Marsh



Editors: Jenny Corsey, Sheila Phinazee & Teresa Valentine • Art & Design: Lynette Rowe

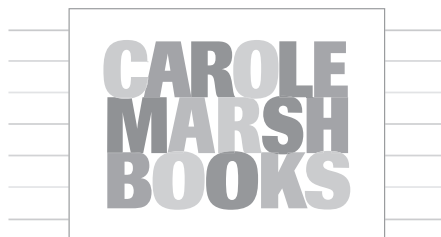

GALLOPADE
INTERNATIONAL



P.O. Box 2779 • Peachtree City, GA 30269
Tel: (800) 536-2438 • Fax: (800) 871-2979
email: orders@gallopade.com
www.gallopade.com

The Mystery on the Iditarod Trail

Dog Sled Craft



Make your own dog sled!



Materials: several clean popsicle sticks, flat wooden toothpicks, wood glue, wire cutters, one long white pipecleaner

1. Lay two popsicle sticks down for runners. Cut two sticks in half. Lay two halves on each other and glue them on the runners, one on each end. Leave a small amount of space on each end. Let it dry
2. Lay four sticks down in the exact middle of the runners (next to one another) as a flat base. Glue them down so that one end fits squarely and the other end sticks out over the runners. Allow it to dry.
3. Cut four more sticks in half. Glue five of the halves together as shown laying the pieces on two more stick halves, which will serve as the back support. Glue one half at the very bottom of the piece and one at the top, but leave a little room at the top so the five curved tops still show (see picture).
4. Glue the piece from Step #3 on the end of the runners where the base ends squarely.
5. Glue two sticks as rails along the base. The flat part of the sticks should face sideways. Glue the tops next to the vertical piece and the bottoms next to the base. The rails should slope downward like a slide.
6. Cut flat toothpicks in three different heights. Make two equal sets of cut toothpicks. Glue them to the side rails and runners at the intervals shown.
7. Cut two small sections of pipecleaner and arch them.
8. Glue one arch at the end of the base for the front of the basket. Glue the other at the top for a handlebar as shown.

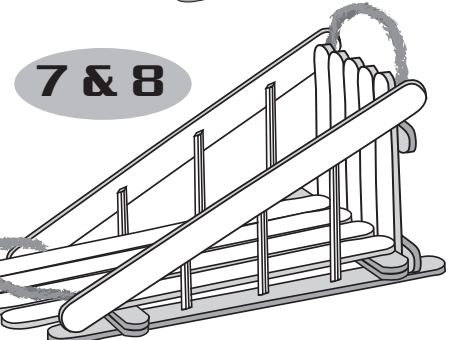
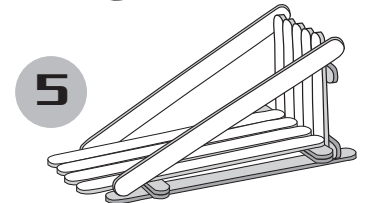
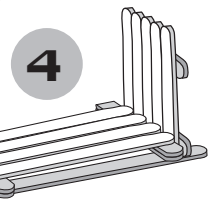
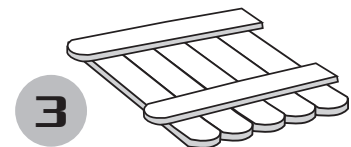
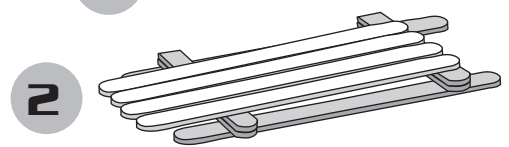
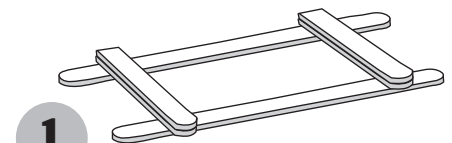

Note: Ask an adult to help you with the wirecutters or pliers!

